

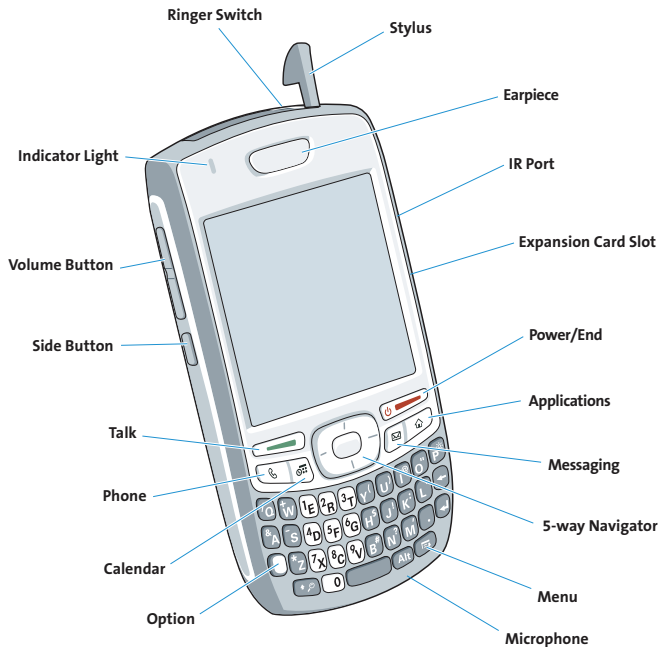

**SETTING UP YOUR
SPRINT POWER VISIONSM SMART DEVICE
TREOTM 755P BY PALM**

Your Treo 755P Smart Device



Welcome to Your Treo 755P Smart Device

Before you begin using your Treo 755P smart device, there are a few simple steps you'll need to take care of:

- 1. Set Up Your Device.**
- 2. Make Your First Phone Call.**
- 3. Connect to Your Computer.**

Once you've completed these simple setup procedures, you'll be ready to begin using all the exciting features of your Treo 755P smart device.

Step

1

Set Up Your Device.

Remove These Items From the Box



Sprint Power Vision
Smart Device Treo™ 755P
by Palm



USB Sync Cable



Sprint Charger
Adapter



Headset

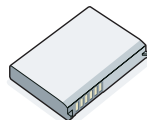

Rechargeable Battery

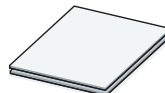

Printed Materials

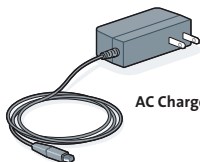

AC Charger



Palm Software Installation CD

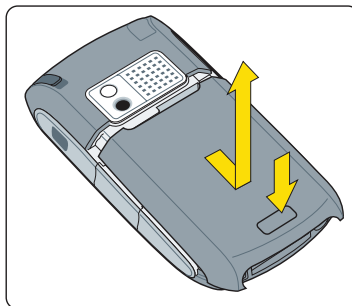
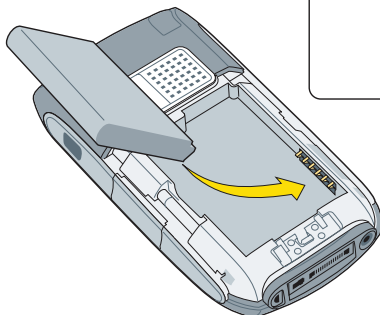

Insert the Battery

- a. Remove the battery door.
- b. Insert the battery.
- c. Replace the battery door.



Check Your Device

Tip: If your device screen turns off while you are setting up or using your device, press **Power/End**  to wake up the screen.

- If you purchased your device at a store, it is ready to use (skip ahead to “Make a Call”).
- If you purchased your device online, check to see if it is locked by pressing **Phone**  .
 - If **Sprint** appears in the upper-left corner of your screen, your phone is ready to use; skip ahead to “Make a Call.”
 - If **Phone Off** appears in the upper-left corner, turn on your device’s phone by pressing and holding **Power/End**  (then skip ahead to “Make a Call”).
 - If **Locked** appears in the upper-left corner, you need to unlock your device.

To unlock your device, enter your four-digit lock code using the keyboard.



If you do not know the code, try the following:
 - The last four digits of your Social Security number.
 - The last four digits of your wireless phone number.
 - 0000 (four zeros).

If none of these works, you may need to activate your phone. Call Sprint Customer Service at 1-888-211-4727 for help.

Step 2

Make Your First Phone Call.

Make a Call

- Press **Phone** .
- Enter the number you want to call.
Tip: There are two ways to enter a phone number: press the numbered keys on the keyboard, or use the stylus to tap the onscreen buttons.
- Press **Talk**  to dial.
- Press **Power/End**  to end the call.

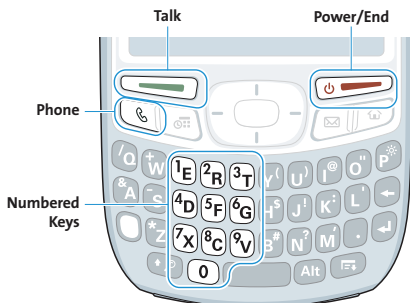

Keyboard



Onscreen Buttons

Set Up Your Voicemail

- a. Press **Phone** .
- b. On the keyboard, press and hold **1**.
- c. Follow the system prompts to:
 - Create your password.
 - Record your name announcement and your greeting.
 - Choose whether to activate **Skip Pass Code**, which lets you access your voicemail without entering your password (if you do not activate **Skip Pass Code**, your device uses **Voicemail Pass Code**, which requires you to enter your password to access your voicemail).

Tip: If you are concerned about unauthorized access to your voicemail account, we recommend that you use Voicemail Pass Code.

What's My Phone Number?

To view your phone number, press **Phone** , press **Menu** , select **Options**, and then select **Phone Info**.

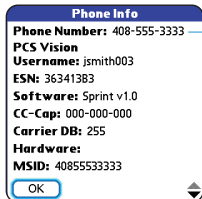

Look Here for Your Phone Number

Step

3

Connect to Your Computer.

Install the Software

IMPORTANT: You must install the software that came with your Treo™ 755P smart device. If you are upgrading your Palm smart device, be sure to synchronize one last time before you install the new software.

Windows Vista users: Before inserting the Palm Software Installation CD, please go to www.palm.com/windowsvista. You'll find installation instructions and information about using your smart device and desktop software with Windows Vista.

- a. Insert the Palm Software Installation CD into your computer's CD drive.
- b. On a Windows computer, follow the onscreen instructions to install the software. On a Mac computer, double-click the CD icon, and then double-click **PalmSoftware.pkg**

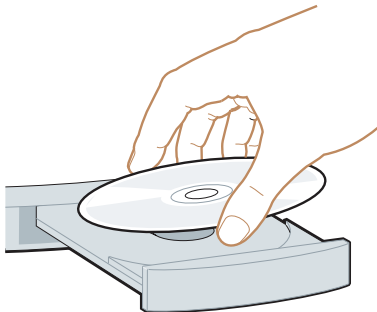

Synchronize

- a. Connect your Treo smart device to your computer.
- b. When prompted to synchronize, press the **Sync** button on the USB sync cable.

What Does the First Synchronization Do?

The first time you synchronize, you set up a relationship between your device and your computer that lets you easily transfer new or updated information any time you sync. This allows you to do tasks such as the following with the press of a button:

- Transfer your contacts, appointments, photos, and videos.
- Install software.

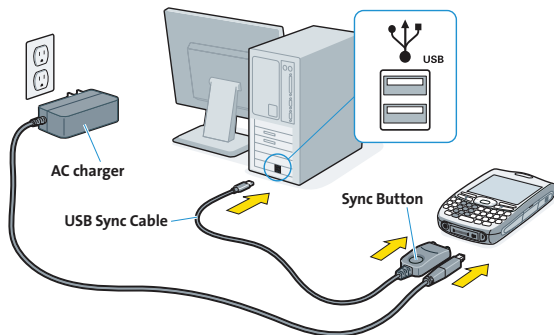

What's Next?





On your smart device

MyTreo

Registration, bonus software, and support. Press **Applications**  and select

MyTreo .

Quick Tour

Introduction to many of your smart device's features. Press **Applications**  and select **Quick Tour** .



In the box

Getting Started Guide

Printed introduction to the basics.

Setting Up Email Guide

Experience Sprint Power Vision



On your computer

User Guide

Hundreds of pages of illustrated information, steps, and tips.

To download the User Guide, go to www.palm.com/mypalm755psprint



On the web

www.palm.com/mypalm/755psprint
www.palm.com/treo755psprint-support